

# AUTO EXPRESS 60



"TURGUT REIS 1" & "CEZAYIRLI HASAN PASA 1"

YARD NO: 54 & 55

DESTINATION: TURKEY

DELIVERED: SEPTEMBER 1997

CLIENT: ISTANBUL DENIZ OTOBUSLERI

## PRINCIPAL DIMENSIONS

Length overall		59.9 metres
Length waterline		51.2 metres
Beam (moulded)		17.5 metres
Depth (moulded)		6.65 metres
Hull draft (approx.)		3.25 metres
Vehicle deck clear heights	Centre lane	4.4 metres
	Side lanes	2.2 metres
	Mezzanine lanes	2.0 metres

## PAYLOAD & CAPACITIES

Passengers		450
Vehicles		94 cars
		or 3 buses & 56 cars
Maximum deadweight		173 tonnes
Maximum axle loads	Centre lanes (dual wheels)	12.0 tonnes
	(single wheels)	9.0 tonnes
	Side lanes	1.0 tonne
	Mezzanine lanes	1.0 tonne
Crew		16
Fuel		24,000 litres

## PROPULSION

Main engines	2 x MTU 20V 1163 TB73L
	65,000kW @ 1,275rpm
Gearboxes	2 x Reintjes Vlj 4431
Waterjets	2 x KaMeWa 125 S11

## PERFORMANCE (with Ride Control fitted)

Speed (340 t DWT, 100% MCR)	35.0 knots
Service speed (340 t DWT, 90% MCR)	33.0 knots
Fuel consumption (approx.) @ 90% MCR	2.46 tonnes/hr

## CLASSIFICATION

Det Norske Veritas  
 † 1A1 R2 Passenger Ferry A EO  
 Turkish Flag Authority



# AUTO EXPRESS 60

Vessel type: 60m High Speed Vehicle-Passenger Catamaran

PROFILE

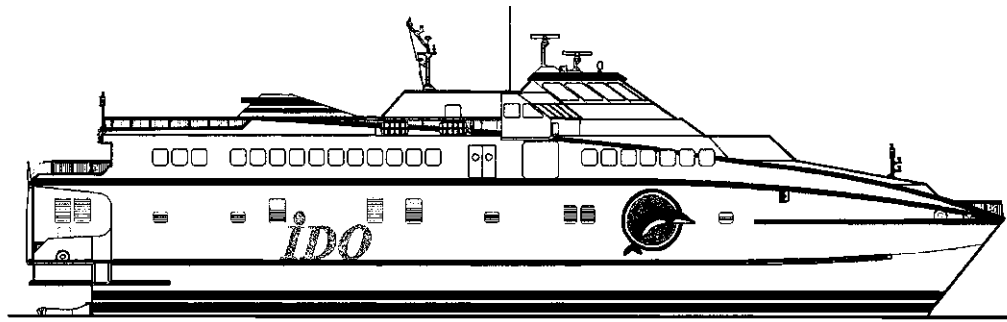

BRIDGE DECK

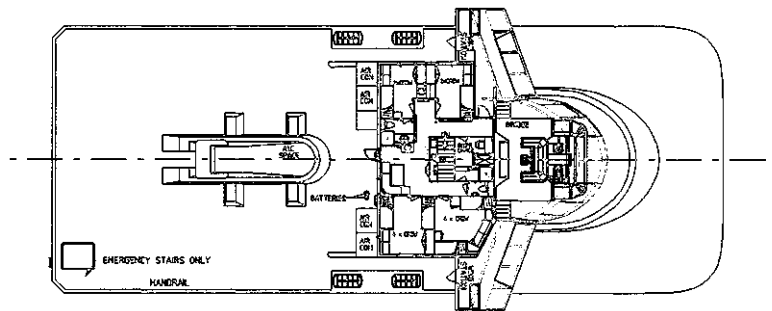

UPPER DECK

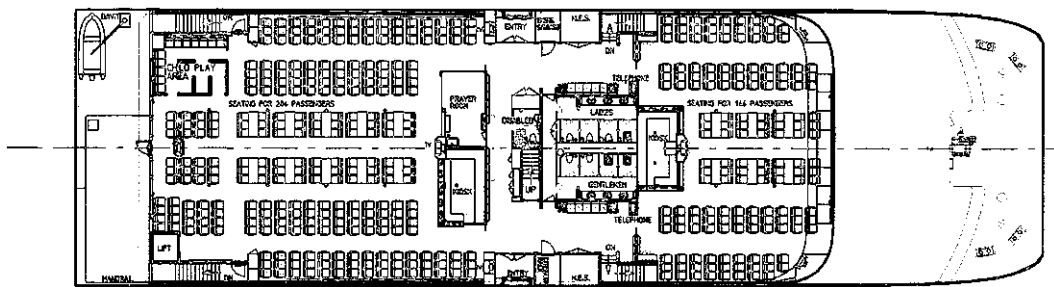

MEZZANINE DECK

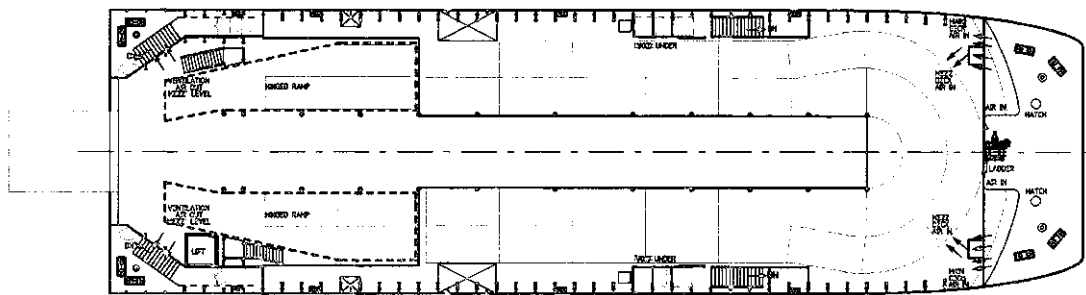

MAIN DECK

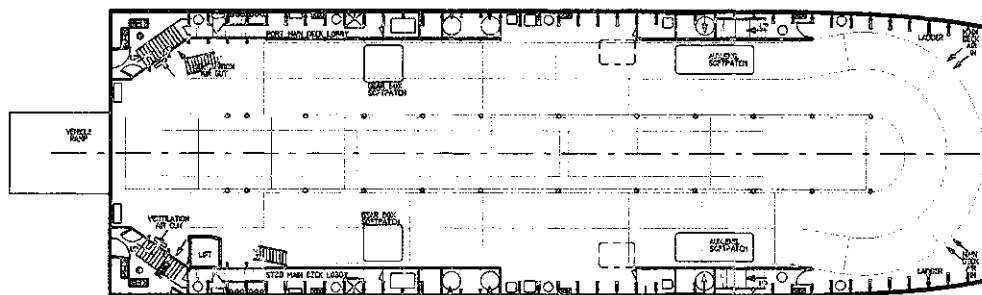

"TURGUT REIS 1" & "CEZAYIRLI HASAN PASA 1"

YARD NO: 54 & 55

DESTINATION: TURKEY

DELIVERED: SEPTEMBER 1997

CLIENT: ISTANBUL DENIZ OTOBUSLERI

100 Clarence Beach Road  
Henderson  
Western Australia 6166

Tel +61 8 9410 1111  
Fax +61 8 9410 2564  
sales@austal.com  
www.austal.com

