

AUSTAL OFFSHORE EXPRESS 33



"KURNAL TIDE"

YARD NO.: 10

DESTINATION: AUSTRALIA

DELIVERED: JUNE 1990

CLIENT: TIDEWATER PORT JACKSON MARINE

PRINCIPAL DIMENSIONS

Length overall	32.9 metres
Length waterline	29.9 metres
Beam (moulded)	8.0 metres
Depth (moulded)	3.0 metres at midships
Hull draft (approx.)	1.8 metres

PAYLOAD & CAPACITIES

Crew	4 + 4
Fuel	20,000 litres

PROPULSION

Main engines	2 x MWM TBD604 V8 633 kW @ 1,800 rpm
Gearboxes	2 x Reintjes WV5 832
Propulsion system	2 x Variable Pitch Propellers

PERFORMANCE

Speed (20 t DWT, 100% MCR)	19 knots
Fuel consumption (approx.) @ 90% MCR	270 litres/hr

CLASS/SURVEY

Det Norske Veritas & Australian Uniform Shipping Laws Class 2B



AUSTAL OFFSHORE EXPRESS 33

Vessel type: 33m Offshore Supply & Support Vessel

PROFILE

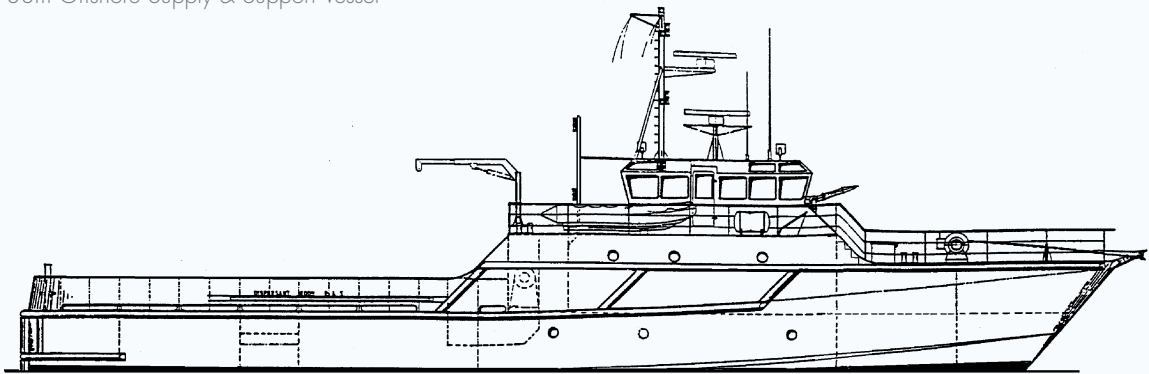

BRIDGE DECK

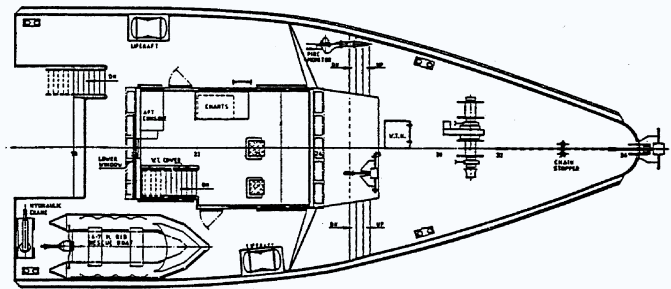

MAIN DECK

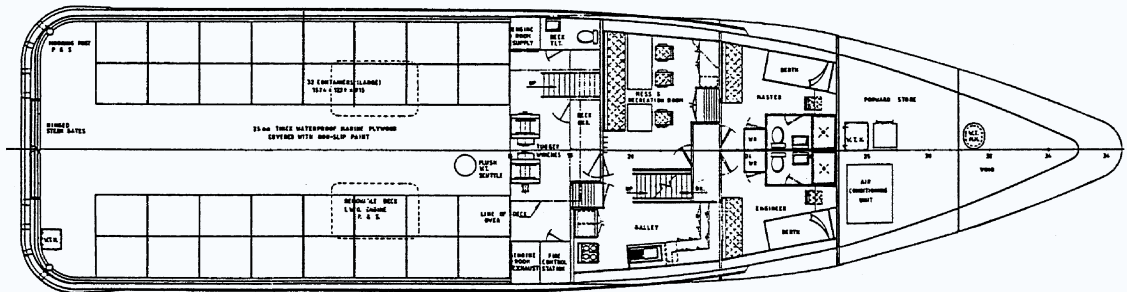

BELOW MAIN DECK

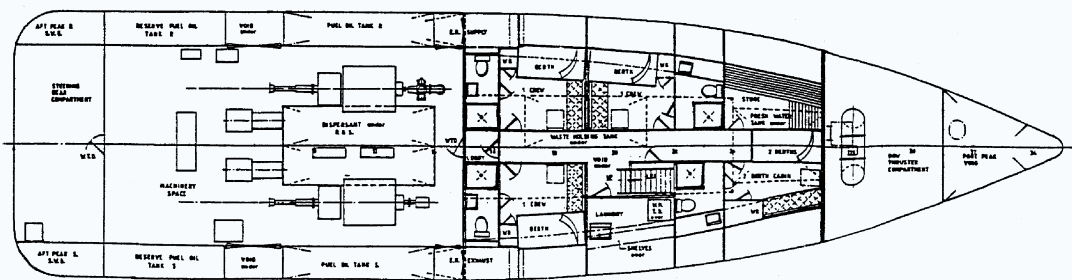

"KURNIA TIDE"

YARD NO: 10

DESTINATION: AUSTRALIA

DELIVERED: JUNE 1990

CLIENT: TIDEWATER PORT JACKSON MARINE

100 Clarence Beach Road
Henderson
Western Australia 6166

Tel +61 8 9410 1111
Fax +61 8 9410 2564
marketing@austal.com
www.austal.com

