

AUSTAL PATROL 22



"KASSIR", "DASTOOR" AND "MAHROOS"

YARD NO: 225 - 227

DESTINATION: KUWAIT

DELIVERED: MARCH 2004

CLIENT: MINISTRY OF INTERIOR, GOVT. OF KUWAIT

GENERAL VESSEL DESCRIPTION

Vessel type	Personnel transport patrol boat
Material	Aluminium alloy
Hull form	Warped planing monohull

PRINCIPAL DIMENSIONS

Length overall	21.6 metres
Length (waterline)	19.6 metres
Beam (moulded)	6.0 metres
Depth (moulded)	3.6 metres
Hull draft (maximum)	1.5 metres

PERSONNEL

Crew	3
Personnel seating	41

PROPULSION

Main engines	2 x MTU 12V 183 TE92 2 x 735 kW @ 2,300 rpm
Gearboxes	2 x ZF1900A
Propellers	2 x fixed pitch

PERFORMANCE

Speed - maximum	25 knots
Fuel consumption	0.3 tonnes/hour
Range	325 nautical miles

CLASSIFICATION

Lloyd's Register
 ✕ 100 A1 SSC
 Patrol Mono HSC ✕ LMC



AUSTAL PATROL 22

Vessel type: Personnel Transport Patrol Boat

YARD NO: 225 - 227

DESTINATION: KUWAIT

DELIVERED: MARCH 2004

CLIENT: MINISTRY OF INTERIOR, GOVT. OF KUWAIT

PROFILE

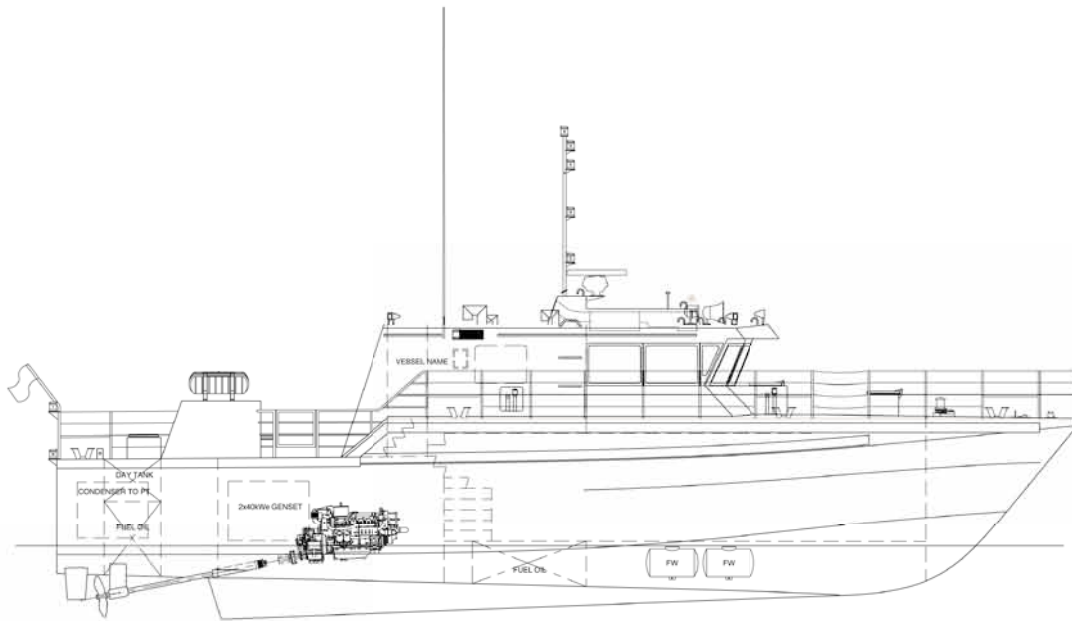

BRIDGE DECK

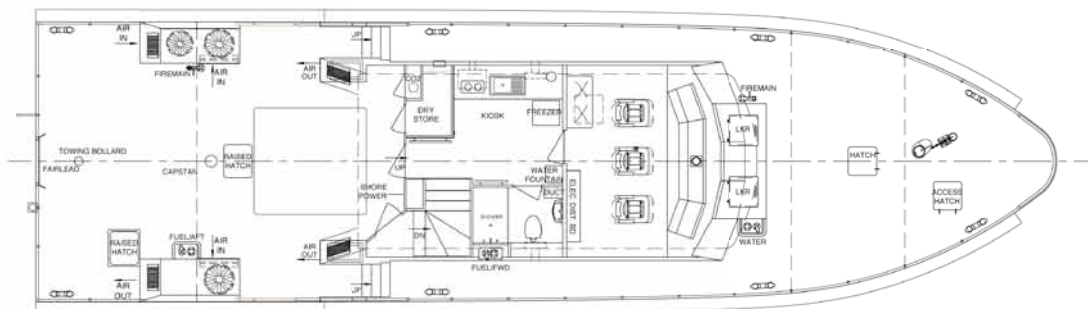

MAIN DECK

