

AUSTAL 35 MONO



“MARY D ODYSSEY”

YARD NO : 274

DESTINATION : NEW CALEDONIA

DELIVERY : JANUARY 2012

CLIENT : MARY D ENTERPRISES

PRINCIPAL DIMENSIONS

Length overall	35.20 metres
Length (waterline)	30.70 metres
Beam (moulded)	7.00 metres
Depth (moulded)	2.70 metres
Hull draft (maximum)	1.20 metres

PAYLOAD AND CAPACITIES

Passengers	138
Crew	12
Full load deadweight	25.50 tonnes
Fuel	15,000 litres

PROPULSION

Main engines	3 x MTU 12V 2000 M72 3 x 1080kW @ 2250 rpm
Gearboxes	3 x ZF 3050
Waterjets	3 x Hamilton HM 521

PERFORMANCE

Speed	36 knots @ 100% MCR
-------	---------------------

CLASSIFICATION

Lloyd's Register
 X100A1 SSC Passenger(A), Mono HSC, LDC, G3
 French Flag



AUSTAL 35 MONO

Vessel Type: Monohull Passenger Vessel

PROFILE



UPPER DECK

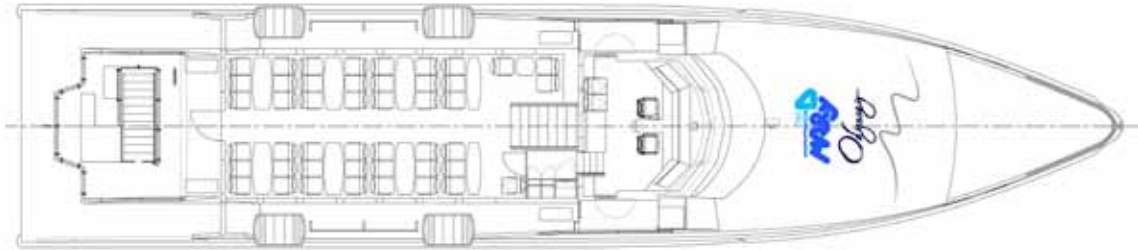

MAIN DECK

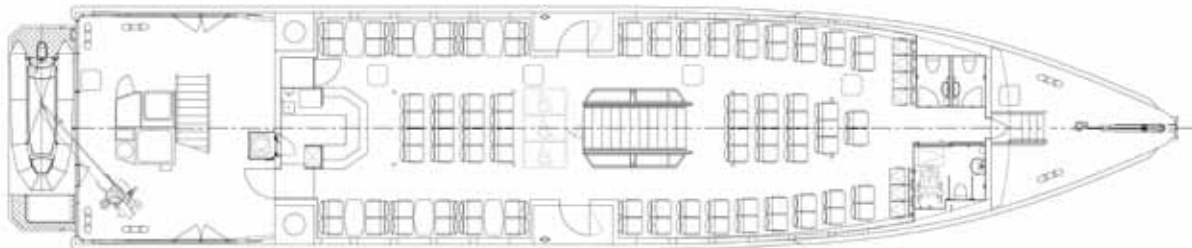

HULL

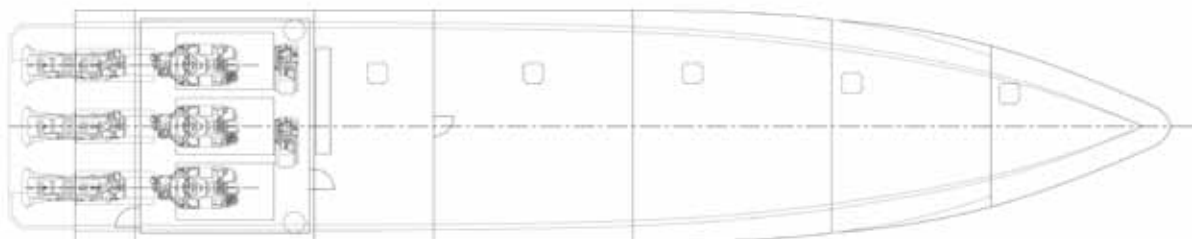

"MARY D ODYSSEY"

YARD NO : 274

DESTINATION : NEW CALEDONIA

DELIVERY : JANUARY 2012

CLIENT : MARY D ENTERPRISES

SHIPS • SYSTEMS • SUPPORT

WWW.AUSTAL.COM

