

AUTO EXPRESS 47



“PERLE EXPRESS”

YARD NO : 249

DESTINATION : GUADELOUPE

DELIVERED : AUGUST 2011

CLIENT : L'EXPRESS DES ILES

PRINCIPAL DIMENSIONS

Length overall	47.0 metres
Length (waterline)	41.2 metres
Beam (moulded)	11.1 metres
Hull depth (moulded)	4.0 metres
Hull draft (maximum)	1.4 metres

PAYLOAD AND CAPACITIES

Passengers	360
Crew	7
Vehicles	10
Main vehicle deck	maximum 1.5 tonnes per axle
Full load deadweight	65 tonnes
Fuel	16,000 litres

PROPULSION

Main engines	2 x MTU 16V 4000 M71 2 x 2,465 kW @ 1,970 rpm
Gearbox	2 x ZF 7650 NR2H
Waterjets	2 x Kamewa 71 SIII

PERFORMANCE

Speed (100% MCR)	34 knots
Range	Approx. 330 nm with 20% reserve

CLASSIFICATION

Bureau Veritas
 1 HULL MACH AUT-CCS, HSC-Cat A, Passenger/Vehicle RoRo
 French Flag



AUTO EXPRESS 47

Vessel type: 47m High Speed Vehicle-Passenger Ferry

“PERLE EXPRESS”

YARD NO : 249

DESTINATION : GUADELOUPE

DELIVERED : AUGUST 2011

CLIENT : L'EXPRESS DES ILES

PROFILE

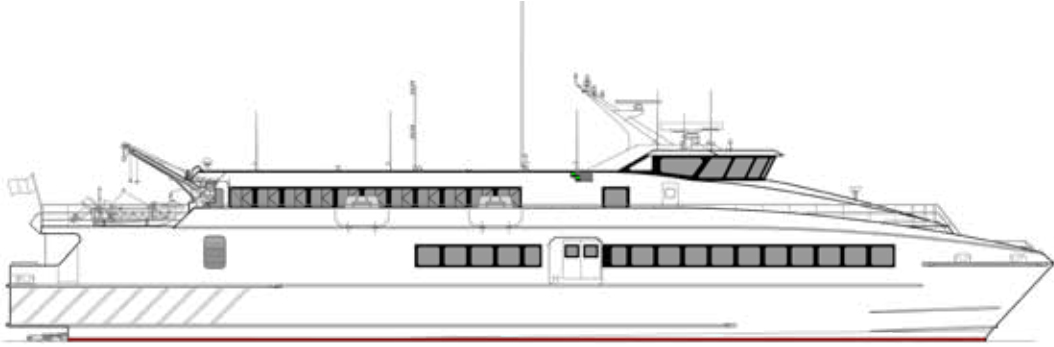

BRIDGE DECK

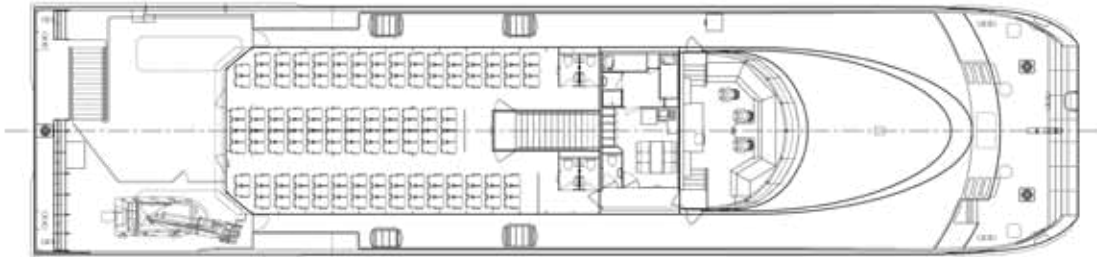

MAIN DECK



HULLS

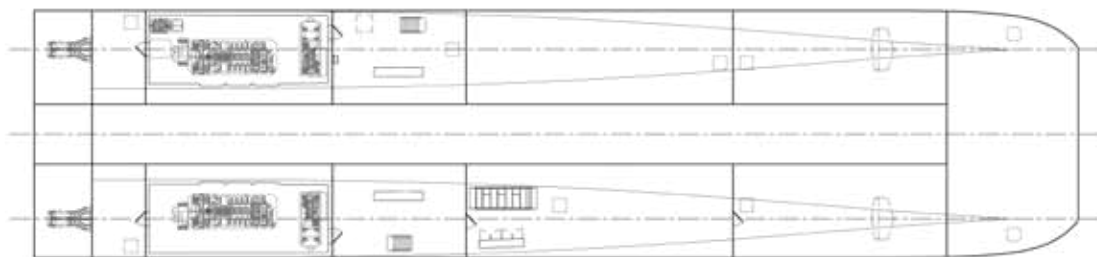

SHIPS • SYSTEMS • SUPPORT

WWW.AUSTAL.COM

